

# WIRE TRAY ASSEMBLY GUIDE

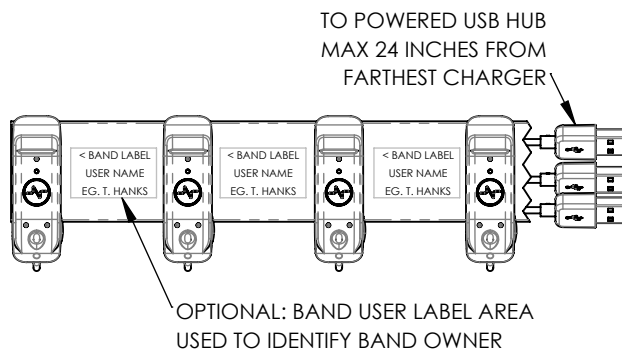

## REQUIRED MATERIALS

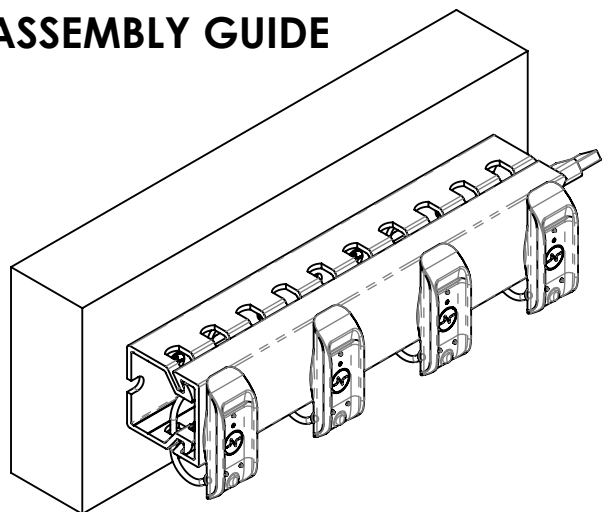
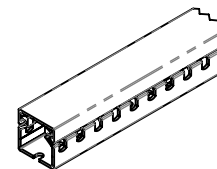

WIRE TRAY (+ TOP COVER)  
MCMMASTER: 7578K16 - 3-1/4FT.  
FITS MAX. 17 CHARGERS

3mm OR 1/8" DRILL BIT AND POWER DRILL  
(NOT SHOWN)

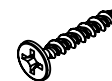

WALL MOUNTING SCREW  
(NOTE: SELECT HARDWARE BASED ON MOUNTING SURFACE)  
EG: MCMMASTER: 90305A112  
RECOMMENDED: x6 OR MORE



STEEL M3 NUT  
MCMMASTER: 90592A085  
x2 PER CHARGER



SHOULDER SCREW  
4MM SHOULDER, M3 x 0.5  
MCMMASTER: 97505A101  
x2 PER CHARGER



M4 STEEL WASHER  
MCMMASTER: 98689A113  
x2 PER CHARGER

### STEP 1:

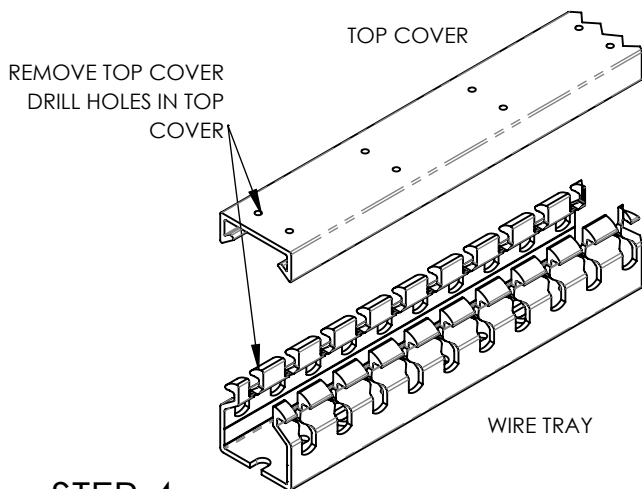

### STEP 2:

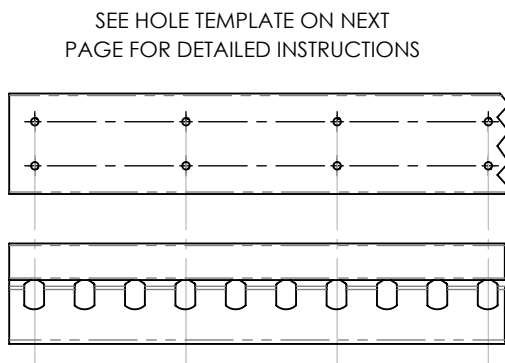

### STEP 3:

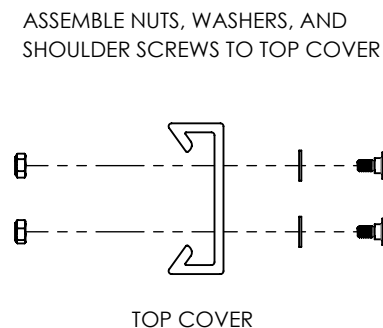

### STEP 4:

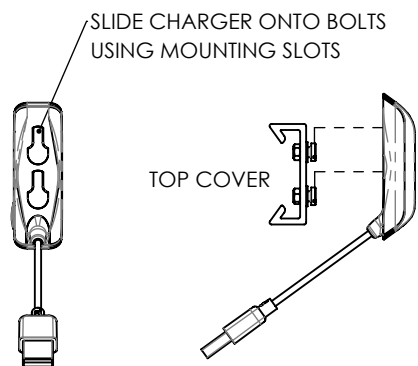

### STEP 5:

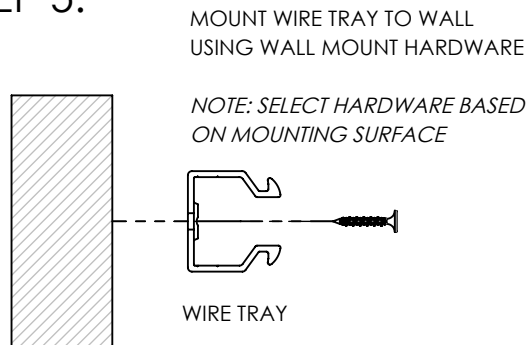

### STEP 6:

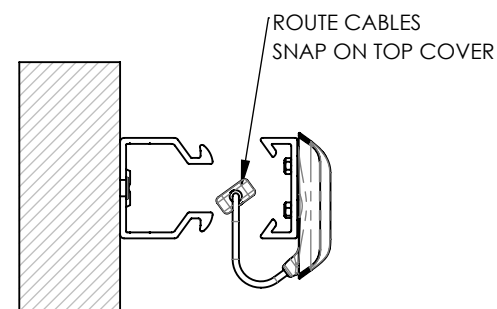

# WIRE TRAY HOLE TEMPLATE

1. ALIGN TEMPLATE  
TO EDGE.

[0.12 min.]  
Ø 3 min. THRU

[0.69]  
17.5

[0.44]  
11.2

[2.36]  
60

4. DRILL HOLES  
USING TEMPLATE.

5. MOVE TEMPLATE.  
DRILL.  
REPEAT AS NEEDED.

2. ALIGN ENDS  
OF TOP COVER  
AND WIRE TRAY.

3. ALIGN FIRST  
HOLES TO GAP  
IN FINGERS.

**SCALE 1:1**  
**PAGE SIZE: 8.5" X 11"**  
**DO NOT SCALE**